

Notice of Non-key Executive Decision

Subject Heading:	Rise Park Parade Consultation Update
Cabinet Member:	Cllr Osman Dervish
SLT Lead:	Barry Francis Director of Neighbourhoods
Report Author and contact details:	Halina Baranowska Project Manager halina.baranowska@havering.gov.uk 01708 434449
Policy context:	Havering Local Development Framework (2008)
Financial summary:	Estimated cost of £0.003m to be funded from cost centre C30000 Highways Improvement Programme (HIP), 2021/22 budget.
Relevant OSC:	Environment
Is this decision exempt from being called-in?	Yes as Non Key Decision by Cabinet Member

The subject matter of this report deals with the following Council Objectives

Communities making Havering	[X]
Places making Havering	[X]
Opportunities making Havering	[X]
Connections making Havering	[X]

Part A – Report seeking decision

DETAIL OF THE DECISION REQUESTED AND RECOMMENDED ACTION

Following on from the informal consultation undertaken between 13th and 31st October 2021, this Executive Decision seeks approval to consider the objections received and implement the following:

- (a) reduce the scale of the project as detailed in Appendix A and progress with the statutory consultation for the implementation of formalised footway parking bays and yellow line in locations where erroneous parking is taking place and sight lines are impaired but without a short stay time limit; as shown in Appendix B; and to
- (b) progress with the implementation of the resurfacing in both Rise Park and Linton Court as per option D – Undertake the resurfacing of the carriageway of Linton Court over a night between the hours of 19:30 to 06:00 (1 night duration)

AUTHORITY UNDER WHICH DECISION IS MADE

Council's Constitution

Part 3, Section 2.5, paragraph (q) To agree minor matters and urgent or routine policy matters

Part 3, Section 2.6, paragraph (y) Portfolios to be assigned to individual Cabinet Members - Highways & Traffic Schemes

STATEMENT OF THE REASONS FOR THE DECISION

(1) Background

- 1.1 Following on from concerns raised by Residents, Businesses and members in relation to erroneous parking and long term parking preventing visitors from being able to park outside of the shops in Rise Park Parade and Linton Court, Romford, the Council has undertaken a review of the parking arrangements and consulted residents and businesses on proposals to implement:
- a) 1 hour (free) parking with no return within 2 hours outside of the shops in Rise Park, which would remain 2 wheels on the footway;
 - b) paid for parking bays opposite and to the south of the shops in the existing inset parking bays; and
 - c) additional double yellow lines along both roads.
- 1.2 In order to mitigate displacement of traffic from Rise Park and Linton Court for residents in Petits Boulevard officers also proposed to introduce 1 hour (free) parking with no return within 2 hours in a number of locations in this road and details of all proposals were provided in the plan.

Non-key Executive Decision

- 1.3 As part of the council's Highways Improvement Plan resurfacing works is being undertaken borough wide and if agreed this would ideally be progressed in both Rise Park Parade and Linton Court in conjunction with these proposals. These works would also include minor alterations to the kerb lines for safety improvements.
- 1.4 To ensure that the resurfacing element causes the minimum of inconvenience officers consulted all residents and businesses regarding the timings for when the works could be undertaken and details were provided in the questionnaire with five options for consideration.

2 Consultation

- 2.1 All three Pettits Ward members have been made aware of the planned consultation and all of the members were in favour of the proposals.
- 2.2 114 consultation packs were sent to residents and businesses on 13th October 2021 with a closing date for responses set at 31st October 2021. The consultation letter and the questionnaire are shown in Appendix A.
- 2.2 The consultation received a low response rate with thirteen in total and details of the responses on:
- a) changes to the parking arrangements and additional waiting restrictions were 2 in favour of the proposals and 11 against.
 - b) resurfacing in Rise Park and Linton Court, 10 in favour and 6 against with 3 opposing option A which was all day working (8am to 5pm) and 3 opposing option D; which was overnight working (7.30pm to 8am).

3 Comments and objections

- 3.1 Following the consultation, the following comments and objections to the proposals were received as follows:
- 3.1.1 *'we have family and friends that visit us regularly as we are old, it will make parking for them more difficult and for family members with young families ie. Babies + disabled, they normally park outside our house No11 were you are saying you want to put a parking bay'*
- 3.1.2 *'I do not want the additional parking on Pettits Boulevard, this road is already tight for parking and if these bays go in all you will do, is push the traffic higher up the road making even harder for residents to park outside their homes. Also, were you are proposing these bays will potentially block residents parking'*
- 3.1.3 *'I am renting this property and when I signed the tenancy it was with car parking so if this proposed parking restrictions are to be implemented where I live also does this mean we also cannot park there as this will leave us nowhere else to park unless we park on other surrounding roads and then have to walk a considerable distance to our own homes. Surely this area should be resident parking only as a few years back there was a barrier that closed to stop anyone parking in Linton court and only residents had access to open the barrier. If you are saying that the restrictions are only for outside the shops then this will mean that all cars will be parking outside our properties which will in turn cause yet more traffic in and out of pettits boulevard as*

Non-key Executive Decision

cars that otherwise would park outside the shops (ie the people whom work in all the shops all day) will be driving through it and parking in Linton court, this will also leave us nowhere to park our own cars which is unacceptable. Residents of the flats above the shops in Pettits boulevard will also park their own cars outside Linton court properties so in short your restrictions will only make parking and through traffic worse for us the people whom actually live here'

- 3.1.4 *'Regarding the proposed parking restrictions for the above I would like to put our points across on how the proposals could negatively affect us. We live at 13 Pettits Boulevard. Looking at the plan there would be restricted parking bays close to our house. We feel this would create problems for us being able to park outside our own property, as other residents would need to find accessible parking nearby once their parking spaces were taken away. Also people that usually park in Rise Park Parade and Linton Court would be looking for alternative parking facilities once all the restrictions were put in place. We feel these proposals will create problems for certain residents which seems very unfair. It seems you will be solving issues for some but creating problems for others. I hope you will take our concerns into account when deciding if the proposals go ahead. It feels as if after all the years we have lived here with no real problems regarding parking this will cause friction and real problems for certain residents of Pettits Boulevard'*
- 3.1.5 *'Please no parking meters. Unable to park outside my home. Impossible for children'*
- 3.1.6 *'My only concern is that the use of parking meters in the bays may cause non-resident cars to park in Linton Court which could cause problems for residents'*
- 3.1.7 *'The road is busy but restrictions will prevent customers accessing the businesses. The area around Linton Court would benefit from the proposals, but not the parade of shops which rely upon customers having access and free parking'*
- 3.1.8 *Could you please explain where the residents of Linton court will park when all the cars from outside the shops of rise park parade will come down the road and park outside of our houses. It is awful to park here already and that is not going to help us in anyway. I have a new born baby and have to park some night miles away from my house which is totally u fair.'*
- 3.1.9 *We are opposed to the proposed nearby parking changes as it will greatly affect parking outside our home and all properties from 237-245 Pettits Lane North. Inevitably vehicles will simply park in the spaces available outside our properties , for as long as they wish, days on end or overnight.*
- 3.1.10 *Large lorries and hgv's need access to deliver goods to the shops and houses on rise park parade and if they can't park there, they will end up blocking our drives , as often happens even now. It is extremely dangerous as our view is blocked to enter and exit our drives to our property., Added to that ,we are on a busy road and there is a bus stop opposite so there are inevitably going to be accidents if sight is blocked when our vehicles are entering/exiting drives. One or 2 large vehicles often park for days or overnight on Rise Park parade and Pettits Boulevard and if they are restricted to 1hour in those roads, they will simply move to parking bays near us. I hope this is taken into consideration as all residents affected are notified and concerns considered and addressed before any action is taken'*

3.2 *If agreed officer's would update respondents with the below statement:*

'Following on from concerns raised by Residents, Businesses and members in relation to erroneous parking and long term parking preventing visitors from being able to park outside of the shops in Rise Park Parade and Linton Court, Romford, the Council undertook a review of the parking arrangements and consulted residents and businesses on proposals to implement:

- a) 1 hour (free) parking with no return within 2 hours outside of the shops in Rise Park, which would remain 2 wheels on the footway;*
- b) paid for parking bays opposite and to the south of the shops in the existing inset parking bays; and*
- c) additional double yellow lines along both roads.*

In order to mitigate displacement of traffic from Rise Park and Linton Court for residents in Petits Boulevard officers also proposed to introduce 1 hour (free) parking with no return within 2 hours in a number of locations in this road and details of all proposals were provided in the plan.

Based on the comments received from the consultation and ward members' comments, it has been agreed to:

- a) reduce the scale of the project and progress with the statutory consultation for the implementation of formalised footway parking bays and yellow line in locations where erroneous parking is taking place and sight lines are impaired but without a short stay time limit; as shown in the attached design; and to*
- b) progress with the implementation of the resurfacing in both Rise Park and Linton Court on a xxxxx between the hours of 08:00 to 17:00 (1 day duration).*

4 Options

- 4.1 The Council has obligations under the Road Traffic Regulation Act (1984) to secure the expeditious, convenient and safe movement of vehicular and other traffic (including cyclists and pedestrians) and to provide suitable and adequate parking facilities on and off the highway.
- 4.2 Officers have considered the need to provide road safety, traffic flow, sight lines and access on Park Rise Parade, Linton Court and Pettits Boulevard, which outweighs the loss of general parking provision. The following options are suggested to be reviewed:
 - a) Continue with the project as originally intended - Progressing with the scheme would alleviate the pressure on Parking Enforcement officers, remove inappropriate parking behaviour, resulting in poor and unsafe conditions for pedestrians.
 - b) Reduce the scale of the project by undertaking the works partially.
 - c) Retain existing parking arrangements and do not progress with the scheme
- 4.3 All three Ward Councillors have been made aware of the responses received to the consultation. Two of them are in favour of the proposals with the reduced scheme, one Councillor didn't respond.

Non-key Executive Decision

5 Recommendation

5.1 Based on the results and the low response rate from the consultation and ward members' comments, it is recommended to:

- c) reduce scale of the project and progress with the statutory consultation for the implementation of formalised footway parking bays and yellow line in locations where erroneous parking is taking place and sight lines are impaired but without a short stay time limit; as shown in Appendix B; and to
- d) progress with the implementation of the resurfacing in both Rise Park and Linton Court as per Option C - Undertake the resurfacing of the carriageway of Linton Court on a Sunday between the hours of 08:00 to 17:00 (1 day duration).

OTHER OPTIONS CONSIDERED AND REJECTED

No other options were considered.

RE-DECISION CONSULTATION

Following on from the informal consultation undertaken between 13th and 31st October 2021 objections were received in relation to proposals to implement short stay parking bays.

All three Pettits Ward members were made aware of the planned consultation and all of the members were in favour of the proposals.

An update was provided to ward members following on from the consultation where in line with the objections received officers recommended reducing the scale of the scheme which was agreed to by the Lead member councillor Osman Dervish.

NAME AND JOB TITLE OF STAFF MEMBER ADVISING THE DECISION-MAKER

Name: Halina Baranowska

Designation: project Manager, Traffic and Parking

Signature:

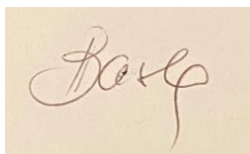

Date: 26th November 2021

Part B - Assessment of implications and risks

LEGAL IMPLICATIONS AND RISKS

The Council's powers to make an order creating a controlled parking zone or for charging for parking on the highway is set out in Part IV of the Road Traffic Regulation Act 1984 ("RTRA 1984") The Council's power to make an order regulating or controlling vehicular traffic on roads is set out in section 6 of Part 1 RTRA 1984. Schedule 1 of the RTRA 1984 lists those matters as to which Orders can be made under section 6. The Traffic Signs Regulations and General Directions 2016 govern road traffic signs and road markings.

Before an Order is made, the Council should ensure that the statutory procedures set out in the Local Authorities Traffic Orders (Procedure)(England & Wales) Regulations 1996 (SI 1996/2489) are complied with.

Section 122 RTRA 1984 imposes a general duty on local authorities when exercising functions under the RTRA. It provides, insofar as is material, to secure the expeditious, convenient and safe movement of vehicular and other traffic (including pedestrians) and the provision of suitable and adequate parking facilities on and off the highway. This statutory duty must be balanced with any concerns received over the implementation of the proposals.

In considering any responses received during consultation, the Council must ensure that full consideration of all representations is given including those which do not accord with the officer's recommendation. The Council must be satisfied that any objections to the proposals were taken into account.

In considering any consultation responses, the Council must balance the concerns of any objectors with the statutory duty under section 122 RTRA 1984.

FINANCIAL IMPLICATIONS AND RISKS

The estimated costs of £0.003m which include advertising costs and implementing the proposal as described above and shown on the attached plan will be met from the C30000 Highways Improvement Programme (HIP), 2021/22 budget, which at the time of this report has sufficient available budget.

HUMAN RESOURCES IMPLICATIONS AND RISKS (AND ACCOMMODATION IMPLICATIONS WHERE RELEVANT)

The proposal can be delivered within the standard resourcing within Highways, Traffic and Parking, and has no specific impact on staffing/HR issues.

EQUALITIES AND SOCIAL INCLUSION IMPLICATIONS AND RISKS

Havering has a diverse community made up of many different groups and individuals. The Council values diversity and believes it essential to understand and include the different contributions, perspectives and experience that people from different backgrounds bring.

The Public Sector Equality Duty (PSED) under section 149 of the Equality Act 2010 requires the council, when exercising its functions, to have due regard to:

- (i) the need to eliminate discrimination, harassment, victimisation and any other conduct that is prohibited by or under the Equality Act 2010;
- (ii) the need to advance equality of opportunity between persons who share protected characteristics and those who do not, and;

Non-key Executive Decision

(iii) foster good relations between those who have protected characteristics and those who do not.

Note: 'Protected characteristics' are: age, sex, race, disability, sexual orientation, marriage and civil partnerships, religion or belief, pregnancy and maternity and gender reassignment.

The council demonstrates its commitment to the Equality Act in its decision-making processes, the provision, procurement and commissioning of its services, and employment practices concerning its workforce. In addition, the council is also committed to improving the quality of life and wellbeing of all Havering residents in respect of socio-economics and health determinants.

Blue badge holders can park on the no waiting at any time restrictions for up to 3 hours in Hazelmere Gardens, Whitmore Estate, Birch Crescent and Blacksmiths Lane. Blue badge holders can also park during restriction times on the single yellow line on Cotswold Road and Upland Court Road.

EQHIA form has been completed and attached as an appendix..

BACKGROUND PAPERS

NONE

APPENDICES

Appendix A - Park Rise Parade – Consultation pack

Informal consultation letter



Havering
LONDON BOROUGH

**IMPORTANT PARKING CONSULTATION
ENCLOSED**

The Resident/Occupier

Highways, Traffic and Parking
London Borough of Havering
Town Hall,
Main Road
Romford RM1 3BB

Phone: 01708 432373

Email: schemes@haverinq.gov.uk

Date: 04 October 2021

Dear Sir/ Madam,

**PROPOSED PARKING SCHEME AND CARRIAGEWAY RESURFACING IN RISE PARK PARADE,
LINTON COURT AND PETTITS BOULEVARD, ROMFORD**

Following on from concerns raised by Residents, Businesses and Local Councillors in relation to erroneous parking in Rise Park Parade and Linton Court, Romford the Council has undertaken a review of the parking arrangements and is now consulting you on proposals to implement:

- 1 hour (free) parking with no return within 2 hours outside of the shops in Rise Park, which will remain 2 wheels on the footway;
- paid for parking bays opposite and to the south of the shops in the inset parking bays; and
- additional double yellow lines along both roads as per attached plan.

In order to mitigate concerns from residents in Petits Boulevard officers are also proposing to introduce 1 hour (free) parking with no return within 2 hours in this road and details of all proposals are provided in the plan overleaf.

As part of the council's Highways Improvement Plan resurfacing works is being undertaken borough wide and if agreed this would ideally be progressed in both Rise Park Parade and Linton Court in conjunction with these proposals. These works would also include minor alterations to the kerb lines for safety improvements.

In the event this parking scheme is not agreed further details would be provided prior the undertaking of the resurfacing works which would mean roads would need to be kept clear of all parked vehicles to ensure that works vehicles and delivery vehicles can be safely manoeuvred.

To ensure that the resurfacing element causes the minimum of inconvenience we would like to consult all residents and businesses regarding the timings for when the works can be undertaken and details are provided in the attached questionnaire where you will find five options for your consideration.

Due to the pandemic officers are currently working from home so please let us know your preferred options by completing the questionnaire at the end of this letter and emailing it to schemes@haverinq.gov.uk and quoting reference 'Rise Park, Parking Consultation' in the title. If you have no / limited access to a computer or internet then you can respond to this consultation via post to Interim Schemes Manager, Town Hall, Main Road, Romford RM1 3BB by 31/10/2021. You can also use this email address if you require any further information

Please note we are unable to answer individual points raised at this stage. However, your comments will be noted and will be taken into consideration when presenting the final report to the Highways Advisory Committee and any issues will be addressed at that time. All comments received are open to public inspection.

To find out your data rights, please see the link below for all details:
https://www.haverinq.gov.uk/info/20044/council_data_and_spending/139/data_protection/1

Yours faithfully,

Diane Bourne
Interim Schemes Manager



Havering

**PROPOSED PARKING SCHEME/CARRIAGEWAY
RESURFACING IN RISE PARK PARADE/
LINTON COURT/PETTITS BOULEVARD**

**Street Management
Schemes
London Borough of Havering
Town Hall
Main Road
Romford
RM1 3BB**

Name:

Email: schemes@havering.gov.uk

Address:

All responses received will provide the council with the appropriate information to determine whether we take a parking scheme forward to the formal consultation stage.

Only one questionnaire per address will be considered. Please respond to us by email schemes@havering.gov.uk by 31st October 2021.

1. Are you in favour of the proposed changes to the parking in your road?

☐ Yes ☐ No

2. Are you in favour of the proposed resurfacing works in your road?

☐ Yes ☐ No

3. If the answer to number 2 is Yes, which option would you prefer?

Option A – Undertake the resurfacing of the carriageway of Linton Court during a standard week day between the hours of 08:00 to 17:00 (1 day duration)

Option B - Undertake the resurfacing of the carriageway of Linton Court during a restricted week day between the hours of 09:30 to 15:30 (2 day duration)

Option C - Undertake the resurfacing of the carriageway of Linton Court on a Sunday between the hours of 08:00 to 17:00 (1 day duration)

Option D – Undertake the resurfacing of the carriageway of Linton Court over a night between the hours of 19:30 to 06:00 (1 night duration)

Option E - No preference

☐ A ☐ B ☐ C ☐ D ☐ E

If you have any additional comments, please provide them below:

Non-key Executive Decision

Informal consultation design

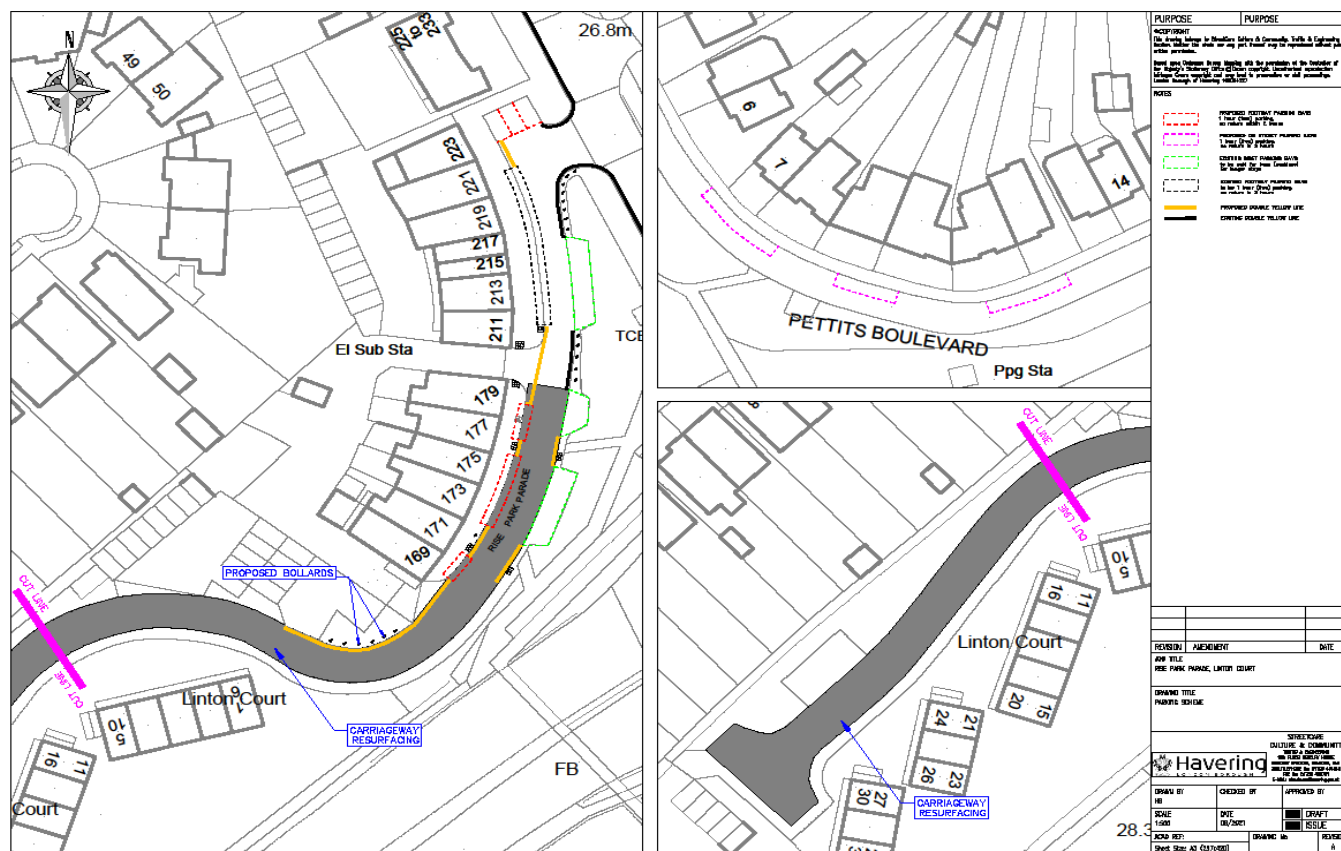

Proposed statutory consultation design

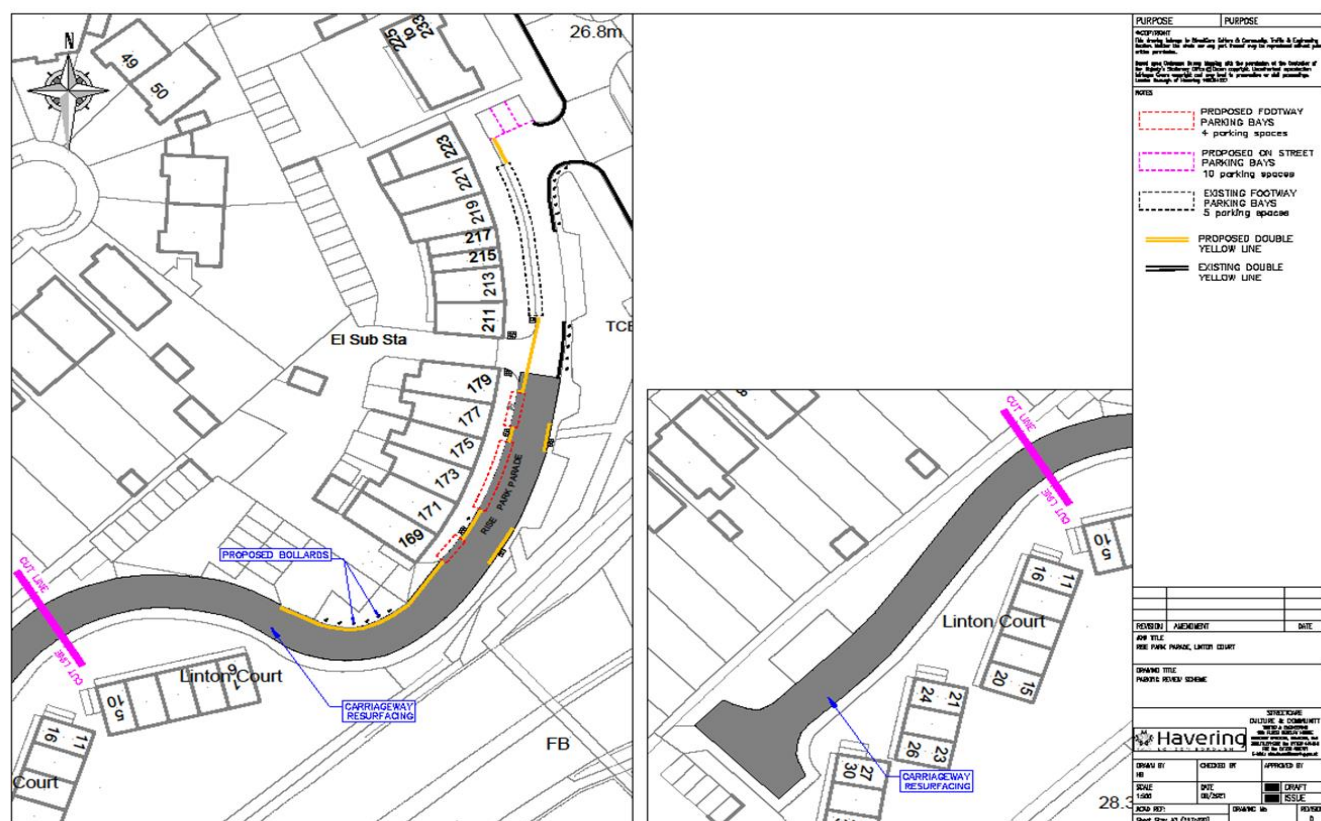

Appendix C



Equality & Health Impact Assessment (EqHIA)

Document control

Title of activity:	Rise Park Parade – Parking review
Lead officer:	Halina Baranowska
Approved by:	Nicolina Cooper
Date completed:	26/11/2021
Scheduled date for review:	26/11/2021

Please note that the Corporate Policy & Diversity and Public Health teams require at least **5**

Did you seek advice from the Corporate Policy & Diversity team?	ED to be sent to diversity for approval
Did you seek advice from the Public Health team?	No
Does the EqHIA contain any confidential or exempt information that would prevent you publishing it on the Council's website?	No

working days to provide advice on EqHIAs.

Please note that EqHIAs are **public** documents and must be made available on the Council's [EqHIA webpage](#).

Please submit the completed form via e-mail to EqHIA@haverling.gov.uk thank you.

1. Equality & Health Impact Assessment Checklist

Please complete the following checklist to determine whether or not you will need to complete an EqHIA and ensure you keep this section for your audit trail. If you have any questions, please contact EqHIA@haverling.gov.uk for advice from either the Corporate Diversity or Public Health teams. Please refer to the Guidance in Appendix 1 on how to complete this form.

About your activity

1	Title of activity	Rise Park Parade – Parking review		
2	Type of activity	Minor Parking schemes		
3	Scope of activity	To implement no waiting at any time restrictions and formalize footway bays		
4a	Are you changing, introducing a new, or removing a service, policy, strategy or function?	Yes	If the answer to <u>any</u> of these questions is 'YES', please continue to question 5 .	If the answer to <u>all</u> of the questions (4a, 4b & 4c) is 'NO', please go to question 6 .
4b	Does this activity have the potential to impact (either positively or negatively) upon people (9 protected characteristics)?	Yes		
4c	Does the activity have the potential to impact (either positively or negatively) upon any factors which determine people's health and wellbeing?	Yes		
5	If you answered YES:	Please complete the EqHIA in Section 2 of this document. Please see Appendix 1 for Guidance.		
6	If you answered NO:			

Completed by:	Halina Baranowska
Date:	26/11/2021

1. The EqHIA – How will the strategy, policy, plan, procedure and/or service impact on people?

Non-key Executive Decision

Background/context:

The following scheme is designed to improve sight lines, traffic flow, road safety, prevent obstruction and access for the emergency services and Council vehicles in Park Rise Parade and Linton Court

Who will be affected by the activity?

The installation of the no waiting at any time waiting restrictions around junctions, bends, access points and opposite junctions would improve road safety, sight lines and access for the emergency services which will of benefit to all residents and their visitors.

These restrictions would impact on the parking capacity for vehicles parking in these locations but blue badge holders can park on the no waiting at any time restrictions for up to three hours.

Residents, their visitors, parents and carers will benefit from introducing footway parking in Park Rise Parade.

Protected Characteristic - Age:

Please tick (✓) the relevant box:

Positive

☐

Neutral

☒

Negative

☐

Overall impact:

Parking restrictions are applied irrespective of age

Protected Characteristic - Disability:

Please tick (✓) the relevant box:

Positive

☐

Neutral

☒

Negative

☐

Overall impact:

Physical Disability:

Blue badge holders can park on the at any time waiting restrictions for up to three hours when displaying their blue badge. Although if there were no restrictions prior to these being installed then blue badge holders could park in this location for an unlimited time.
Blue badge holders can park on the waiting restriction during the restricted hours for an unlimited time.

For the definition of 'eligible', please see section 2 (background/context)

Evidence:

(Please add in any additional evidence and use the evidence below that is relevant for your particular impact assessment, please delete unnecessary data)

Sources used:

Protected Characteristic - Sex/gender:

Protected Characteristic - Age:

Non-key Executive Decision

<i>Please tick (✓) the relevant box:</i>		Overall impact: For the definition of 'eligible', please see section 2 (background/context) Parking restrictions are applied irrespective of sex/gender
Positive		
Neutral	✓	
Negative		
Evidence: <i>(Please add in any additional evidence and use the evidence below that is relevant for your particular impact assessment, please delete unnecessary data)</i>		
Sources used:		
Protected Characteristic - Ethnicity/race: Consider the impact on different ethnic groups and nationalities		
<i>Please tick (✓) the relevant box:</i>		Overall impact: For the definition of 'eligible', please see section 2 (background/context) Parking restrictions are applied irrespective of Ethnicity/race
Positive		
Neutral	✓	
Negative		
Evidence: <i>(Please add in any additional evidence and use the evidence below that is relevant for your particular impact assessment, please delete unnecessary data)</i>		
Sources used:		
Protected Characteristic - Religion/faith		
<i>Please tick (✓) the relevant box:</i>		Overall impact: Parking restrictions are applied irrespective of religion / faith
Positive		
Neutral	✓	
Negative		
Sources used:		
Protected Characteristic - Sexual orientation		
<i>Please tick (✓) the relevant box:</i>		Overall impact:
Positive		
Neutral		
Negative		

Non-key Executive Decision

Positive		Parking restrictions are applied irrespective of sexual orientation
Neutral	✓	
Negative		
Evidence:		
Sources used:		
Protected Characteristic - Gender reassignment: Consider people who are seeking, undergoing or have received gender reassignment surgery, as well as people whose gender identity is different from their gender at birth		
<i>Please tick (✓) the relevant box:</i>		Overall impact:
Positive		Parking restrictions are applied irrespective of gender reassignment
Neutral	✓	
Negative		
Evidence:		
Sources used:		
Protected Characteristic - Marriage/civil partnership: Consider people in a marriage or civil partnership		
<i>Please tick (✓) the relevant box:</i>		Overall impact:
Positive		Parking restrictions are applied irrespective of marriage/civil partnership
Neutral	✓	
Negative		
Evidence:		
Sources used:		
Protected Characteristic - Pregnancy, maternity and paternity		
<i>Please tick (✓) the relevant box:</i>		Overall impact:
Positive		Parking restrictions are applied irrespective of pregnancy, maternity and paternity
Neutral	✓	

Non-key Executive Decision

Negative		
Evidence:		
Sources used:		
Health & Wellbeing Impact: Consider both short and long-term impacts of the activity on a person's physical and mental health, particularly for disadvantaged, vulnerable or at-risk groups. Can health and wellbeing be positively promoted through this activity? Please use the Health and Wellbeing Impact Tool in Appendix 2 to help you answer this question.		
<i>Please tick (✓) all the relevant boxes that apply:</i>		Overall impact:
Positive		The introduction of at any time waiting restrictions will increase road safety, sight lines, prevent obstruction and increase access for the emergency and Council vehicles, which would reduce accidents and worry for residents / visitors using the public carriageways and footways. However, the introduction of no waiting at any time restrictions may add to the stress for residents and their visitors by the loss of a number of unrestricted on street parking spaces.
Neutral	✓	
Negative		
		Do you consider that a more in-depth HIA is required as a result of this brief assessment? Please tick (✓) the relevant box <div style="text-align: right;">Yes No ✓</div>
Evidence: To be added.		
Sources used:		
Socio – Economic impact:		
<i>Please tick (✓) the relevant box:</i>		Overall impact:
Positive		Parking restrictions are applied irrespective of socio-economic status. Free parking is still available close by in these locations.
Neutral	✓	
Negative		
Evidence:		
Sources used:		

2. Review

In this section you should identify how frequently the EqHIA will be reviewed; the date for next review; and who will be reviewing it.

Review: 26/11/2021
Scheduled date of review: 26/11/2021
Lead Officer conducting the review: Halina Baranowska

Non-key Executive Decision

Please submit the completed form via e-mail to EqHIA@haverling.gov.uk
Thank you.

Part C - Record of decision

I have made this executive decision in accordance with authority delegated to me by the Leader of the Council and in compliance with the requirements of the Constitution.

Decision

Proposal agreed

- (a) reduce scale of the project and progress with the statutory consultation for the implementation of formalised footway parking bays and yellow line in locations where erroneous parking is taking place and sight lines are impaired but without a short stay time limit; as shown in Appendix B;
- (b) progress with the implementation of the resurfacing in both Rise Park and Linton Court as per option D – Undertake the resurfacing of the carriageway of Linton Court over a night between the hours of 19:30 to 06:00 (1 night duration)

Details of decision maker

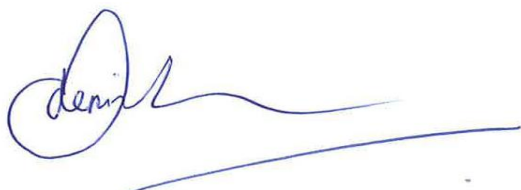

Signed

Name: **Councillor Osman Dervish**

Officer: **Lead Member for Environment**

Date: **17/01/2022**

Lodging this notice

The signed decision notice must be delivered to the proper officer, Debra Marlow, Principal Democratic Services Officer in Democratic Services, in the Town Hall.

For use by Committee Administration

Non-key Executive Decision

This notice was lodged with me on _____

Signed _____